



Remanufactured or brand new?
You decide.



Remanufactured

- + OE part repaired with aftermarket components
- + Costly surcharge
- + Time consuming
- + 6-8 weeks wait for surcharge
- + Potential risks with part

“

Your competitors are already selling **brand new product** in the marketplace taking advantage of no surcharge and no grey costs. Make sure your customer base doesn't go elsewhere!

New units =
Consolidated store!

Brand New from BGA

- + Brand new, no surcharge
- + No old core
- + No handling old units
- + No money tied up in surcharges
- + No loss of internet sales
- + OE Specification quality
- + Worldwide trusted brand
- + Zero risks with quality



Brand New Driveshafts and CV Joints from BGA

- + Over 2,000 references - more than 710 top CV joints & more than 1350 top Driveshafts
- + No core, no surcharge - saving time and money
- + Consistent OE equivalent quality.



INNER RACE

The inner race makes surface contact with the balls. As with the ball bearings the Inner Race is surface finish tested to ensure the exact tolerance between the balls and the inner race, as well as hardness tested to ensure longevity of the joint.

BALL BEARING

The balls are critical to ensure the smooth running of the CV Joint. The balls are surface finish tested to ensure the exact specification is reached as well as hardness tested to ensure longevity of the joint.

WHEEL HUB BOLT

Hardness tested to ensure a matching OE specification. All bolts are manufactured at the same BGA facility as our market leading range of Cylinder Head Bolts.



CV JOINT

The CV Joint (Constant Velocity) allows a drive shaft to transmit power at different angles, at a constant rotational speed, without hindrance. BGA's CV Joints are real world tested to ensure optimum performance. As well as surface, hardness and endurance testing, 100% inspected with go / no go" spline gauges to ensure that the critical tolerance of the shaft splines is accurate.

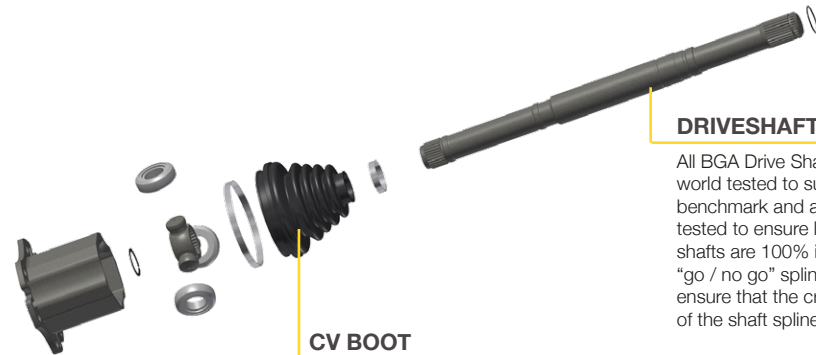

DRIVESHAFT

All BGA Drive Shafts are real world tested to surpass the OE benchmark and are hardness tested to ensure longevity. All shafts are 100% inspected with "go / no go" spline gauges to ensure that the critical tolerance of the shaft splines is accurate.

CV BOOT

The CV Joints are protected by a rubber boot, usually filled with MoS2 grease. It is critical that contaminants are kept away from the joints, any split or failure within the boot could lead to a premature failure of the joint / shaft.



Brand New Power Steering Pumps from BGA

- + Over 550 part numbers
- + Range includes hydraulic and electric hydraulic pumps
- + Premium quality, matching OE specifications
- + No core, no surcharge - saving time and money
- + Consistent OE equivalent quality



FLOW CONTROL VALVE

Pulleys are dimensionally designed according to OE parameters, paying special attention to V-rib profile, pulley thickness and welding sections to avoid noise and vibration. Pulleys are endurance tested to ensure longevity before release to market.

OE SEALS

BGA boast over 90 years of group manufacturing, specialising in OE Seals.



FLOW CONTROL VALVE

Flow control valves are tested prior to fitment in the pump to ensure the correct relief pressure.

ROTOR & VANES

Hardness and surface finish are tested to ensure consistent tolerance between the rotor and vanes.

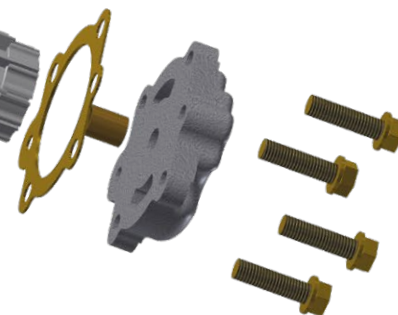

Testing Certificate with each pump:

- Leak test
- Pressure test
- Volume efficiency test
- Flow performance test
- Cleanliness test



www.bgautomotive.co.uk
sales@bgautomotive.co.uk | +44 (0) 1793 491 777