



THE SYMPTOMS

- Engine damage
- Excessive wear/failure of the chain
- Inconsistent tension due to changing oil volumes
- Blockage of chain lubrication holes

THE REASON

- Excessive oil consumption
- Internal engine contamination
- Carbonization blocking oilways through the cylinder head

THE SOLUTION

- Inspect the camshaft bearings for signs of wear or scoring, this indicates poor lubrication
- Ensure the oil feed holes on the front face of the gasket are not blocked
- Replacement of the oil pump is recommended whilst changing the timing chain kit
- An engine flush is recommended alongside the installation of these parts
- Ensure that an adequate oil level is maintained at all times



TC0150FK



IT IS RECOMMENDED THAT OIL CONDITION IS CHECKED BEFORE INSTALLATION OF NEW COMPONENTS. CLEAN OIL IS RECOMMENDED BEFORE THE INSTALLATION

TC0150FK / TC0151FK

General Advice

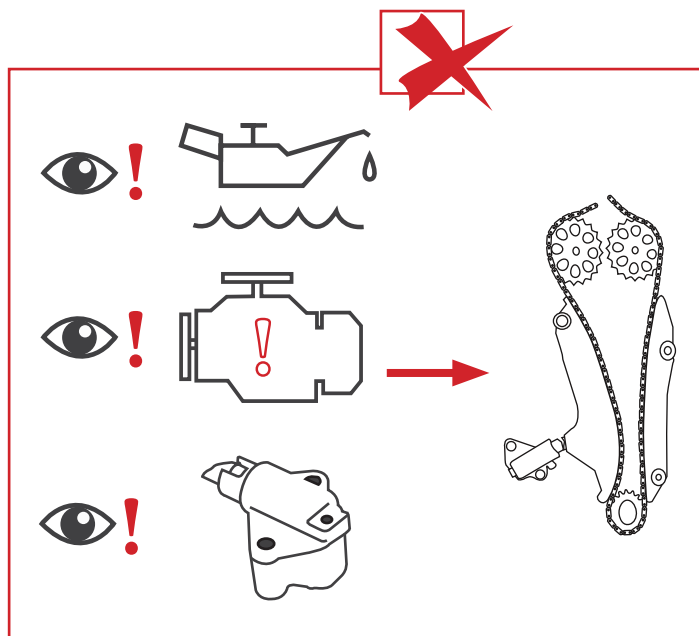
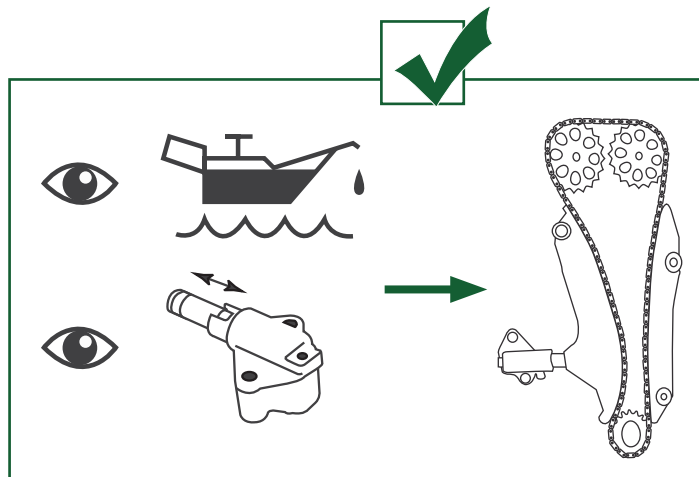

IMPORTANT



FAILURE TO MAINTAIN AN ADEQUATE LEVEL OF OIL MAY LEAD TO PREMATURE FAILURE OF THE TENSIONER. THIS CAN CAUSE DAMAGE TO THE ENGINE



BGA products are to be replaced by an experienced automotive installer. This information is to be used as reference only. Always seek manufacturer specification.

